

# NIPISSING

U N I V E R S I T Y

**FACT SHEET**

**ACADEMIC YEAR 2024 - 2025**

**INTERNATIONAL EXCHANGE UNDERGRADUATE STUDIES**





**NIPISSING UNIVERSITY**

100 College Drive,  
North Bay, Ontario,  
Canada

Tel: +1 705.474.3450

Website : <http://www.nipissingu.ca>

Map : <https://map.nipissingu.ca/>

International Office

Sabah Khan

International Mobility Coordinator

Telephone : +1 705 - 474 - 3450 Ext – 4212

E-mail : [internationalmobility@nipissingu.ca](mailto:internationalmobility@nipissingu.ca)



## APPLICATION – EXCHANGE STUDENTS



### Fall semester

Nomination : May 1, 2024

- 1 Semester (September to December)
- Full Academic Year (September to April)

Application Deadline: May 20, 2024

Online application : [Incoming Exchange Students | Nipissing University](#)



### Winter semester

Nomination : September 1, 2024

- 1 Semester (January to April)

Application Deadline: September 20, 2024, Winter

Online application : [Incoming Exchange Students | Nipissing University](#)



Contact : [internationalmobility@nipissingu.ca](mailto:internationalmobility@nipissingu.ca)



### Programs at Nipissing University:

[All Programs | Nipissing University](#)

·Note – The following programs are not accepting exchange student currently

- Bachelor of Physical & Education
- Graduate Studies
- Bachelor of Nursing
- Consecutive Bachelor of Education (Schulich School)

### International Exchange Application Information:

<https://www.nipissingu.ca/departments/international-mobility/incoming-exchange-students>

**\*Note** – Academic Callender's are published May each year.

## ACADEMIC CALENDAR 2024 - 2025:

[Academic Dates | Nipissing University](#)

### FALL SEMESTER:

Orientation	August 2024
Lectures	September 2024 – December 2024
Examinations	November-December
Transcripts	January
Request Transcripts	

[Transcripts | Nipissing University](#)

[Nipissing University Transcript Request Form](#)



\* New academic calendars are published May each year



### WINTER SEMESTER:

Orientation	January 2025
Lectures	January 2025 – April 2025
Examinations	April
Transcripts	June
Request Transcripts	

[Transcripts | Nipissing University](#)

[Nipissing University Transcript Request Form](#)



Our friendly university staff, mentors and tutors from the International Student Office will be happy to help you settle into the university quickly by completing all formalities before your orientation day, supporting you with a smooth transition and other social events where you can get to know fellow international and local students.





## Language Expectations

While no formal test is required, we do encourage incoming exchange students to ensure that their level of English language proficiency meets or exceeds our standard as follows.



### •Test of English as a Foreign Language (TOEFL):

Applicants to all programs except Nursing require a minimum score of 83 (iBT) with a minimum score of 20 in reading, listening and writing, and a minimum score of 22 in speaking. Applicants to Nursing require a minimum score of 93 with a minimum score of 20 in reading and listening and a minimum score of 22 in writing and speaking. The Nipissing University TOEFL institution code is #3614

### •International English Language Test Service (IELTS):

Applicants to all programs except Nursing require a minimum overall band score of 6.5 with a minimum 6 in reading, listening, speaking and writing. Applicants to Nursing require a minimum overall band score of 7 with a minimum 6.5 in reading, listening, speaking and writing.

### •Pearson Test of English (PTE) Academic:

Applicants to all programs except Nursing require a minimum overall score of 58 with a minimum score of 56 in speaking, writing, reading and listening. Applicants to Nursing require a minimum overall score of 63 with a minimum score of 60 in each section.

### •Canadian Academic English Language (CAEL/CAEL Online):

Applicants to all programs except Nursing require a minimum overall score of 60 with no band less than 60. Applicants to Nursing require a minimum overall score of 70 with no band less than 60.

### •Cambridge English Qualifications:

A C1 minimum overall score of 176 with a minimum score of 169

## SEMESTERS

At Nipissing University courses can either be taught in one semester or over a period of two semesters.

Two semester courses run from September to April and have designated code of FW meaning Fall and Winter. Two semester courses are worth six credits.

Single semester courses are taught in either our Fall semester (FA = September to December) or the Winter semester (WI = January to April). Single semester courses are typically worth 3 credits.



### ECTS CREDITS

15 Nipissing University credits = 30 ECTS Credits

## ACCOMODATION – ON CAMPUS LIVING

Nipissing University offers on campus housing. Note that all exchange students must submit a personal application directly if you are considering on campus living.

Applications should be submitted through the eRezlife portal at :  
[www.nipissingu.ca/applytoresidence](http://www.nipissingu.ca/applytoresidence)

Please note that students should apply as early as possible to ensure they have a confirmed room at the residence.

Furnished rooms in student residences <https://www.nipissingu.ca/departments/residence/rates>

### Suite-Style Residences

sample layout

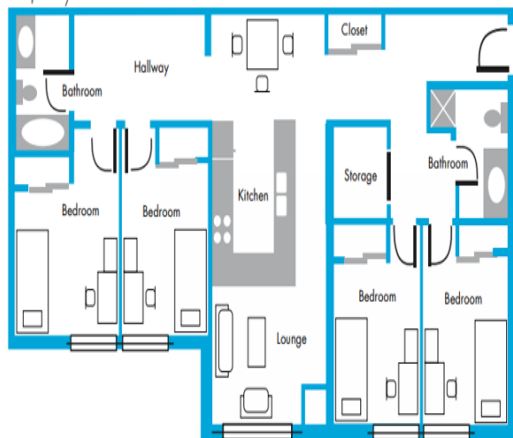

## Residence

A private bedroom of your own

### Your NU Home

Our top-rated residences will make you feel right at home. You can count on making fast friends within your residence community while also enjoying the luxury of a private room of your own in a four-bedroom suite. Living in residence means you'll be surrounded with personal and academic supports, new friends from around the world, and exciting experiences and memories that will last long after graduation.

### Be Part of the Action!

Get involved and make lifelong friendships by taking part in movie nights, road hockey tournaments, board games, paint nights, cooking tutorials, ping-pong tournaments and more! Our dedicated student leaders always have something exciting planned. Have an idea for your own event? Let our student leaders know and they'll make it happen!

### Lakers Support Lakers

From the moment you step into residence at Nipissing University, you're part of a vibrant community filled with helpful and caring student leaders. Residence Dons are supportive and fun upper-year students who organize events, monitor community safety, and offer a helping hand around-the-clock. Community Assistants are upper-year students who help students take accountability for, and positively contribute to, the residence community. Academic Dons help you build your academic skills outside the classroom, and the Residents' Council Executives advocate on your behalf and lead exciting events.

### Service is a Step Away

Every residence building features its own Front Desk with supports and services available to all residents. Whether you need to get laundry change, have an essay printed, grab some dish soap, borrow a board game, or have a question, the Residence Front Desk is your place to go.

### Living Learning Communities

Live with friends who like the same things you do in one of our four Living Learning Communities (LLC). The communities bring together students who share similar interests, and provide an immediate support network.

#1 in  
RESIDENCE LIVING  
in primarily undergraduate  
universities in Canada  
- Maclean's 2022



Therapy dog visits reduce stress

Governors House

Chancellors House

Founders House

Meal Plans - [Dining on Campus | Nipissing University](http://www.nipissingu.ca/dining)



**INSURANCE INFORMATION**

All international students are responsible to have a valid insurance that covers their travel and the duration of their stay

- Travel insurance to and from Canada
- UHIP (University Health Insurance Plan) \$63/ month

For more information visit:

[University Health Insurance Plan | Nipissing University](#)

**VISA AND STUDY PERMIT FOR CANADA**

Under the Immigration, Refugees and Citizenship Canada (IRCC) regulations, if a student's period of study in Canada is 6 months or less, they are not required to obtain a Study Permit. However, students are encouraged to research the visa criteria to ensure a smooth exchange transition. For students studying for a full academic year (8 months) it is mandatory to obtain a study permit from the country of origin.

For more information visit the IRCC website at:

[Study in Canada as an international student - Canada.ca](#) .

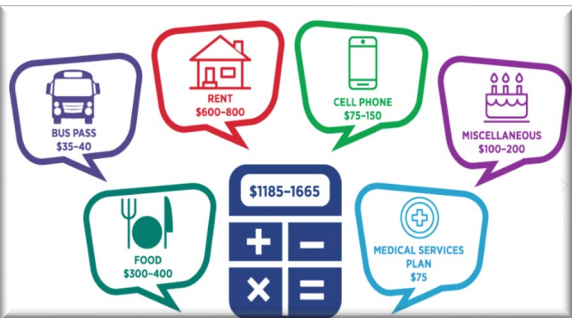

**COST OF LIVING**

Monthly cost of living is approximately CAD \$ 2000.

**\*Note** – This does not include the tuition fee, books and other supplies





# EXPLORE North Bay

## Location and arrival to Nipissing University

Nipissing University is in North Bay a city in Northeastern Ontario, Canada.

The city is located 300 kilometers (190 mi) from both Ottawa and Toronto.

Public transport: bus can easily access most of the campuses.

You have three options for transportation to/from Pearson International Airport in Toronto to/from Nipissing University campus or another location in North Bay, Ontario.

- 1) Connecting flight from the Toronto Airport to the Jack Garland Airport in North Bay
- 2) Northern Airport Shuttle Service
- 3) Ontario Northland Bus Lines

For more information about locations and how to arrive, please email: [internationalmobility@nipissingu.ca](mailto:internationalmobility@nipissingu.ca)

**NOTE: Nipissing University does not offer airport pickup in Toronto for incoming students**



## Discover North Bay

[Discover North Bay | Nipissing University](https://www.nipissinglakers.com/north-bay)

<https://www.nipissinglakers.com/north-bay>



NORTH BAY  
Explore for  
the weekend,



# NIPISSING

## U N I V E R S I T Y

### INTERNATIONAL OFFICE CONTACT SHEET

**INTERNATIONAL MOBILITY COORDINATOR**

[internationalmobility@nipissingu.ca](mailto:internationalmobility@nipissingu.ca)

**ACADEMIC ADVISING**

[internationaladvising@nipissingu.ca](mailto:internationaladvising@nipissingu.ca)

**RESIDENCE LIFE**

[residence@nipissingu.ca](mailto:residence@nipissingu.ca).

**INTERNATIONAL STUDENT SUPPORT**

[internationalmobility@nipissingu.ca](mailto:internationalmobility@nipissingu.ca)

**REQUEST TRANSCRIPTS**

<https://www.nipissingu.ca/transcripts>